

“Gudi” is your partner in creative solutions for acoustical problems. We have wide range of comprehensive solution for every environmental and indoor acoustic.

TAB Timber Absorptive & Diffusive Panels – a evolution of wooden features with superior acoustic performance. Beyond the sound wave, it is a splendid environment.

Selection Guide:

Strip – Installation by tongue and groove system

Model: 13/3C , 14/2C, 28/4C, panel type

*Dimension: 128 x 2440mm (curved surface), 192 x 2440mm (Flat Surface), 1200 x 2400mm (tailor-made panel type)

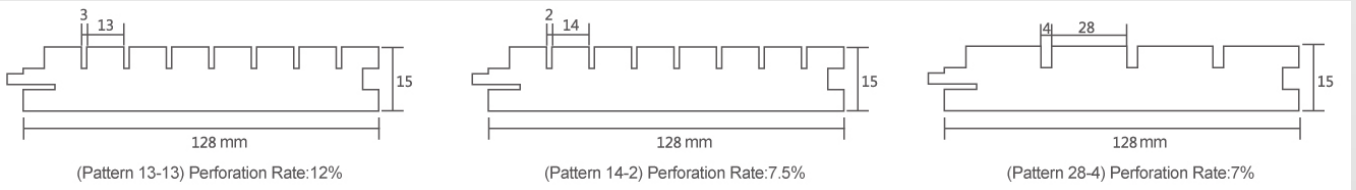

Panel –Installation by butt jointing with varies recess and reveal accessories.

Model: 16-16-6, 8-8-1 MicroPerf (or any pattern upon request)

*Dimension: 600 x 600mm, 600 x 1200mm, 1200 x 2400mm

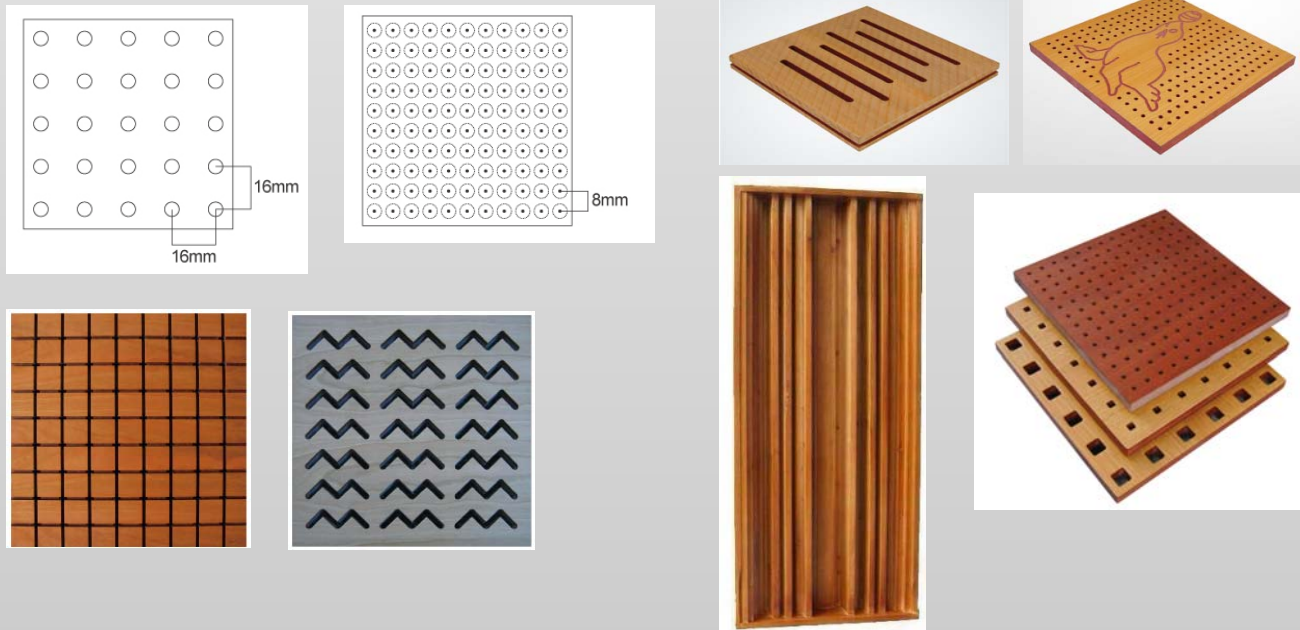

Core Material: E1 Graded MDF Board (std / black) / Moisture Resistant MDF Board / Fireproof MDF Board

Finish: Veneer / ECO Melamine Paper / Plastic Laminated Sheets / Painting

Surface Density: 4 – 12 kg/m²

Flow-Resistance Membrane: Black Fibreglass Tissue / non-woven Fabric

Acoustic Performance: NRC 0.4 – 1.0 / Diffusion Index 0.2 – 1.0 / Reflective Type



*Standard dimension. We could produce the panels in desired dimension upon request.



APAC Building Acoustics Limited

Room 802, Shatin Galleria, 18-24 Shan Mei Street,

Fotan, N.T., Hong Kong

Tel: (852) 2786 5900

Fax: (852) 2786 5728

E-mail: info@apacba.hk



“Gudi” is your partner in creative solutions for acoustical problems. We have wide range of comprehensive solution for every environmental and indoor acoustic.

Installation Methodology:

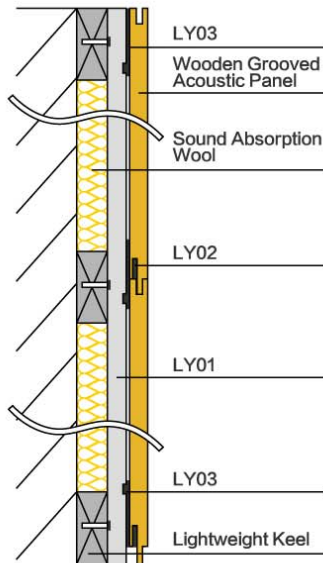

Cross-section Structure

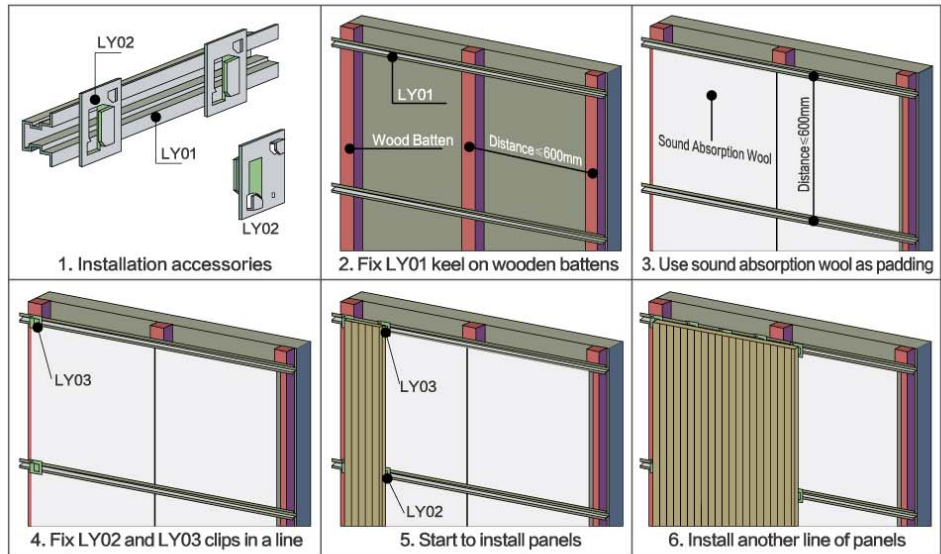

Installation: Lightweight Steel Keel System

Installation System I (with gap)

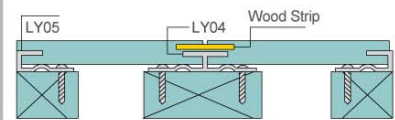
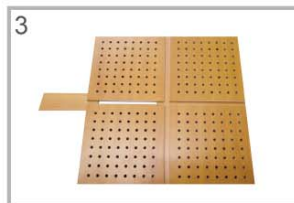
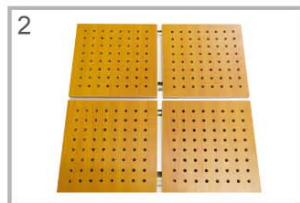

Cross-section Structure

Installation System II (without gap)

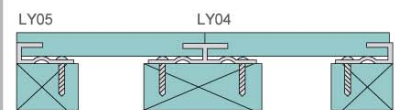
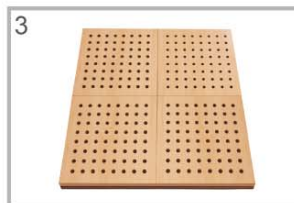

Cross-section Structure



APAC Building Acoustics Limited

Room 802, Shatin Galleria, 18-24 Shan Mei Street, Fotan, N.T., Hong Kong

Tel: (852) 2786 5900

Fax: (852) 2786 5728

E-mail: info@apacba.hk



“Gudi” is your partner in creative solutions for acoustical problems. We have wide range of comprehensive solution for every environmental and indoor acoustic.

Job Reference:



HKJC – Shatin Private Box



Sound diffusion is the efficiency by which sound energy is spread evenly in a given environment. A perfectly diffusive sound space is one that has certain key acoustic properties which are the same anywhere in the space. A non-diffuse sound space would have considerably different reverberation time as the listener moved around the room. Acoustic diffusors can not only ad sound diffusion, but also remove coloration and echoes. They are often used in music training rooms, recording rooms, churches, multi-functional rooms, theatres, concert halls and so on.

Guangzhou Dance School



APAC Building Acoustics Limited

Room 802, Shatin Galleria, 18-24 Shan Mei Street,
Fotan, N.T., Hong Kong
Tel: (852) 2786 5900
E-mail: info@apacba.hk

Fax: (852) 2786 5728



"Gudi" is your partner in creative solutions for acoustical problems. We have wide range of comprehensive solution for every environmental and indoor acoustic.

Acoustic Performance:

Model:	Air Cavity (mm)	Infill:	Absorption coefficient (1/1 Octave band Centre Frequency):						
			125	250	500	1K	2K	4K	NRC
6/2C	175	Y (25)	0.42	0.95	0.66	0.63	0.62	0.51	0.70
13/3C	100	Y (50)	0.40	1.00	0.95	0.75	0.70	0.65	0.85
13/3C	75	Y(25)	0.38	0.80	0.91	0.67	0.62	0.57	0.75
14/2C	75	Y(25)	0.30	0.87	0.89	0.64	0.60	0.54	0.75
28/4C	75	Y(25)	0.41	0.87	0.82	0.54	0.44	0.44	0.65
16/16/2C	75	Y(25)	0.34	0.92	0.42	0.15	0.12	0.08	0.40
16/16/3C	75	Y(25)	0.32	0.79	0.70	0.29	0.25	0.12	0.50
16/16/5C	75	Y(25)	0.37	0.80	0.73	0.40	0.29	0.29	0.55
16/16/6C	75	Y(25)	0.41	0.75	0.78	0.50	0.37	0.38	0.60
8/8/1C	100	Y(50)	0.50	0.85	0.55	0.25	0.10	0.10	0.45
9/9/6C	100	Y(50)	0.35	0.95	0.85	0.60	0.45	0.35	0.70

"Gudi" TAB Acoustic Performance

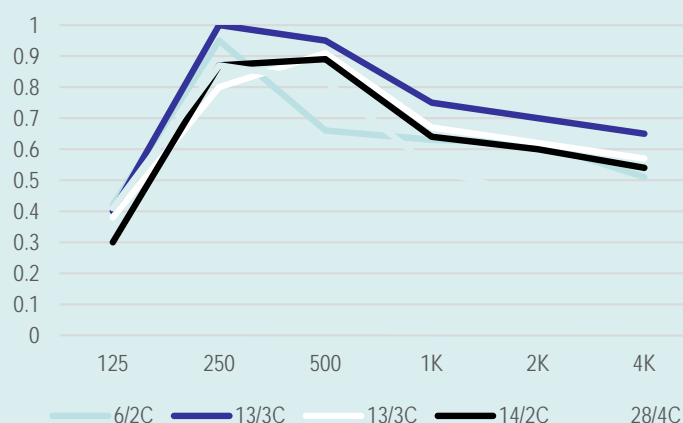

"Gudi" TAB Acoustic Performance

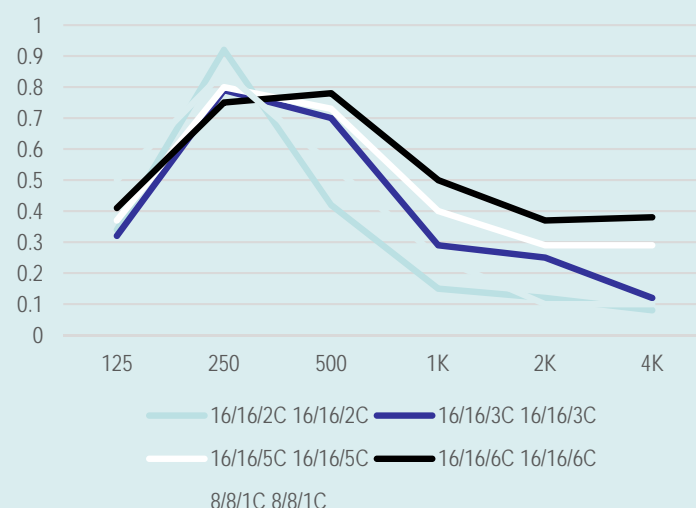

Model:	Air Cavity (mm)	Infill:	Absorption coefficient (1/1 Octave band Centre Frequency):						
			125	250	500	1K	2K	4K	NRC
Gudi-F	50	Y(25)	0.10	0.35	0.60	0.80	0.75	0.75	0.65
Gudi-AL-28/3C	100	N	0.10	0.20	0.55	0.50	0.40	0.45	0.40

Alternative solution:

Gudi-F: Fabric Selection (25/50mm)

Infill materials: Polyester Fiber / **"SonexAsia"** Acoustic Foam / Fiberglass / Rockwool

Gudi-AL: Perforated Aluminum Selection

With Infill: Polyester Fiber / **"SonexAsia"** Acoustic Foam / Fiberglass / Rockwool

Without infill: **"Megasorber"** Water Repellent Acoustic Fleece.



APAC Building Acoustics Limited

Room 802, Shatin Galleria, 18-24 Shan Mei Street,

Fotan, N.T., Hong Kong

Tel: (852) 2786 5900

E-mail: info@apacba.hk

Fax: (852) 2786 5728

